

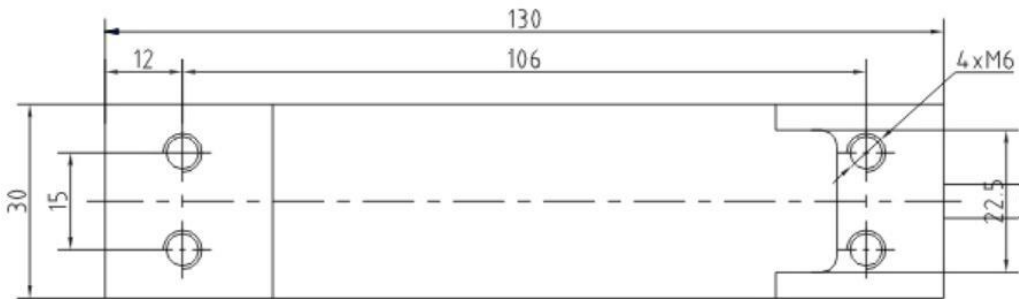

Stainless Steel Single Point Load Cells SMI-SS

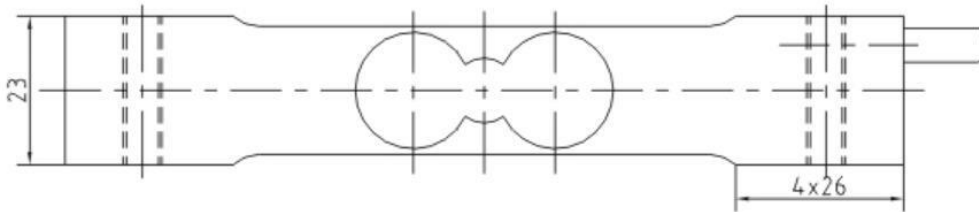

Wiring Diagram

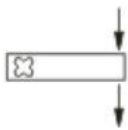
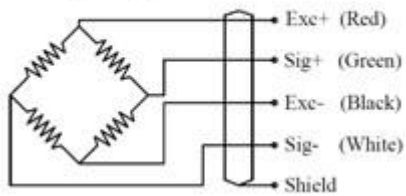

Specification

Application :	All kinds of platform scale
Model :	SMI-SS
Capacity	5,8,10,15, 20,30,35,40kg
Output Sensitivity	2.0± 0.2 MV/V
Accuracy Class	OIML C3
Creep(30 min)	±166ppm
Zero Balance	±3%Emax
TCO	±17.5ppm°C
TC SPAN	+20°C-+40°C,±17.5ppm°C
	-10°C-+20°C,±11.67ppm°C
Input Impedance	404 ± 15Ω
output Impedance	350 ± 3Ω
Max Platform Size	300×300MM
Insulation Resistance	≥2000 MΩ (50VDC)
Recommend Excitation Voltage	10V
Maximum Excitation Voltage	15V
Operating Temperature Range	-20~+50°C
Safe Overload	150 %Emax
Ultimate Overload	300 %Emax
Protection Grade	IP65
Material	Stainless Steel
Cable Length	Φ5× 1M
Recommended Installation Torque	10N.m