

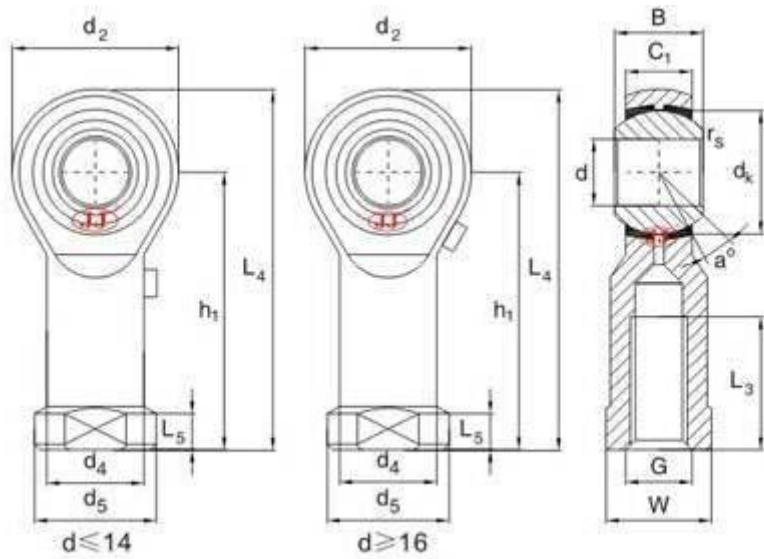

Load Cells Male Rod Ends Bearing PHS Series



Specification:

Type	Dimensions (MM)															Loading	Static loading	G.W.
Bearing number	D H7	B	d _x	C ₁ max	D ₂ max	G 8H	H ₁	L ₃ min	L ₄ max	L ₅	W	d ₄	d ₅		a°	Load ratings kN/ Dynamic	Load ratings kN/ Static	Weight =kg
PHS5	5	8	11.112	6	16	M5	27	10	35	4	9	8.5	11	0.3	13	3.3	4.1	0.016
PHS6	6	9	12.7	6.75	18	M6	30	12	39	5	11	10	13	0.3	13	4.3	5.3	0.026
PHS8	8	12	15.88	9	22	M8	36	16	47	5	14	12.5	16	0.3	14	6.8	8.5	0.044
PHS10	10	14	19.05	10.5	26	M10	43	20	56	6.5	17	15	19	0.6	14	10	11	0.072
PHS10-1	10	14	19.05	10.5	26	M10*1.25	43	20	56	6.5	17	15	19	0.6	14	10	11	0.072
PHS12	12	16	22.23	12	30	M12	50	22	65	6.5	19	17.5	22	0.6	13	13	14	0.108
PHS12-1	12	16	22.23	12	30	M12*1.25	50	22	65	6.5	19	17.5	22	0.6	13	13	14	0.108
PHS14	14	19	25.4	13.5	34	M14	57	25	74	8	22	20	25	0.6	16	17	20	0.108
PHS14-1	14	19	25.4	13.5	34	M14*1.5	57	25	74	8	22	20	25	0.6	16	17	20	0.161
PHS16	16	21	28.58	15	38	M16	64	28	83	8	22	22	27	0.6	15	21	25	0.161
PHS16-1	16	21	28.58	15	38	M16*1.5	64	28	83	8	22	22	27	0.6	15	21	25	0.225
PHS18	18	23	31.75	16.5	42	M18*1.5	71	32	92	10	27	25	31	0.6	15	26	30	0.295
PHS20	20	25	34.93	18	46	M20*1.5	77	33	100	10	30	27.5	34	0.6	15	31	35	0.382
PHS22	22	28	38.1	20	50	M22*1.5	84	37	109	12	32	30	38	0.6	15	38	43	0.488
PHS25	25	31	42.86	22	60	M24*2	94	42	124	12	36	33.5	42	0.6	15	47	65	0.749
PHS28	28	35	47.83	25	66	M27*2	103	48	136	12	41	37	46	0.6	15	59	77	0.949
PHS30	30	37	50.8	25	70	M30*2	110	51	145	15	41	40	50	0.6	17	63	66	1.13
PHS30-1	30	37	50.8	25	70	M27*2	110	51	145	15	41	40	50	0.6	17	63	86	1.13

For left-hand thread , suffix L is added to bearing number and thread sign, e.g. PHSL20 M20*1.5L-6H

Sliding contact surfaces:Steel/Bronze

Design and application features

Rod end of steel and zinc coated , with male or female thread , spherical surface with bronze liner, inner ring of carbon chromium steel , spherical surface with chromium plating, can be lubricated via a nipple or a hole in the rod end , It has characteristics of large load capability , easy mounting and dismounting and mechanism simplification .

ADD: UNIT 615A 6F ZHONG TIE FORTUNE PLAZA NO.398 JIAHE ROAD XIAMEN FUJIAN CHINA

TEL:86-592-6686182, Email:sales@kuanyi.com, <http://www.kuanyi.com>