

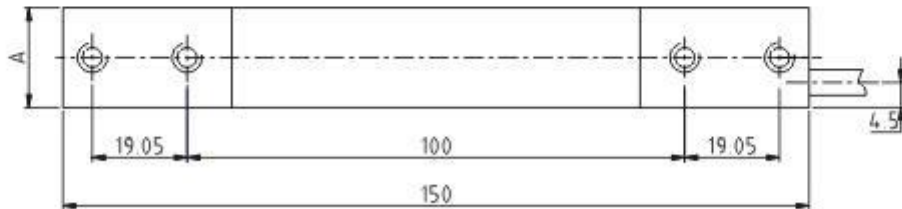

### Single Point Load Cells AMH

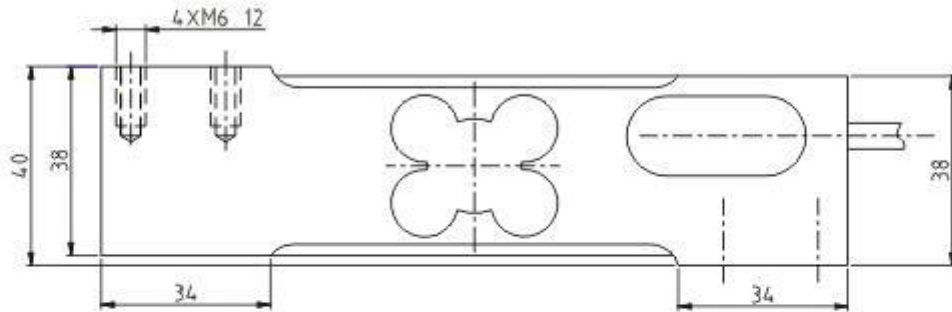

量程(Kg)	A
8 - 30	20
50 - 200	25

### Wiring Diagram

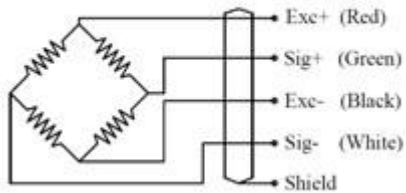

**Specification**

Application :	All kinds of platform scales, bench scales
Model :	AMH
Capacity	10,20,30,50,100 KG
Output Sensitivity	2.0± 0.2 mV/V
Accuracy Class	C3, C5
Creep(30 min)	166ppm/30 Mins
Zero Balance	±3 % Emax
TCO	17.5PPM/°C
TC SPAN	15 PPM/°C
Input Impedance	404 ± 15 Ω
output Impedance	350 ± 3Ω
Insulation Resistance	≥2000 MΩ (50V DC)
Recommend Excitation Voltage	10V
Maximum Excitation Voltage	15V
Compensated Temperature Range	-10~+40°C
Operating Temperature Range	-20~+50°C
Safe Overload	150 %F.S
Ultimate Overload	200 %F.S
Protection Grade	IP66
Material	Alluminium
Cable Length	3M Φ4 (10-30KG); Φ5(50-100KG)