

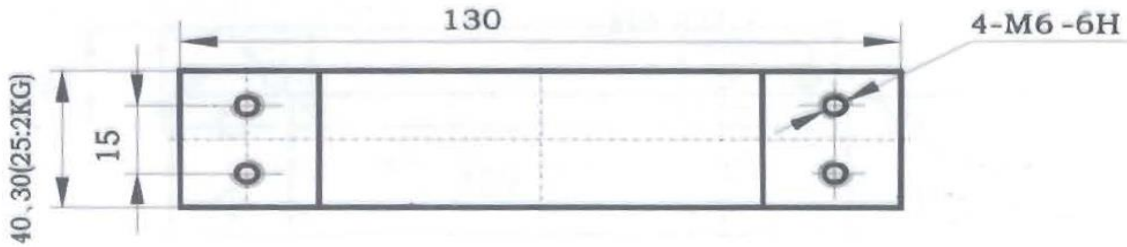

### OIML Single Point Load Cells AMB

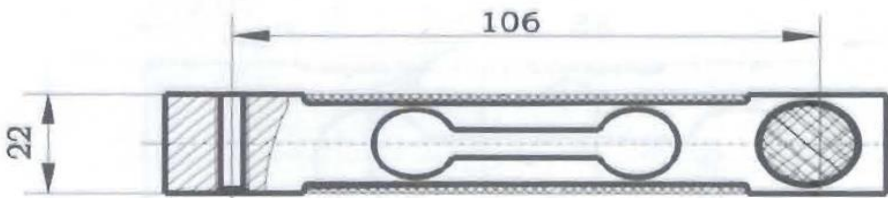

#### Wiring Diagram

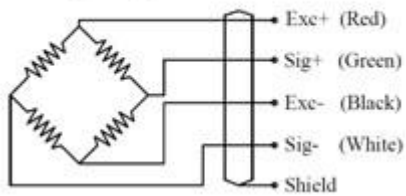

## Specification

Application :	Price Computing Scales , Bench Scales
Model :	AMB
Capacity	3, 5, 10, 20, 30, 40,50, 80,100,120 KG
Output Sensitivity	2.0± 0.2 MV/V
Nonlinearity	0.02 %F.S
Repeatability	0.02 %F.S
Hysteresis	0.02 %F.S
Creep(30 min)	0.02 %F.S/30 Mins
Temperature effect on Sensitivity	0.03 %F.S/10℃
Temperature effect on Zero	0.034 %F.S/10 ℃
Zero Balance	< 1.5%F.S
Input Impedance	405 ± 10Ω
output Impedance	350 ± 5Ω
Insulation Resistance	5000 MΩ
Recommend Excitation Voltage	10V
Maximum Excitation Voltage	15V
Compensated Temperature Range	-10~+40℃
Operating Temperature Range	-20~+60℃
Safe Overload	120 %F.S
Ultimate Overload	150 %F.S
Protection Grade	IP65
Material	Aluminium
Cable Length	φ4× 0.35 M
Recommended Platter Size	300 × 300 MM